



CAMPSITE
"DE LA CITÉ D'ALETH"



Your holiday
in a CooCo!



campingsaintmalo@gmail.com

+33 (0)2 90 63 02 13

camping-saintmalo.fr



Welcome to Cité d'Aleth campsite !

The Cité d'Aleth (or Alet) is just a few hundred metres from the old town, near the port of Bas Sablons.

Wild and peaceful, it offers superb views over the Bay of Saint-Malo, Dinard and the Rance estuary. Historically, the Cité d'Aleth is also home to a fort occupied by the Germans during the Second World War. Completely surrounded by water, this peninsula really is a little corner of paradise, with all the local shops you need.

The Cité d'Aleth campsite is a place for sharing and exchanging ideas. It's a place where everyone can find their place: on their own, as a couple, as a family, with friends or in a camp. You can come on foot or by bike to pitch your tent or stay in a caravan, van or camper van.

The region is full of treasures!

The campsite's location is ideal for discovering and enjoying the Malouin coastline, its exceptional environment and unique history will enrich your stay.

Set sail for the Emerald Coast!



The campsite is open from Thursday 28 March (2pm) to Monday 30 September 2024 (12pm).



Reception is open :
daily from 09:00 to 18:30
July and August: daily from 08:00 to 20:00



Telephone reception :
every day from 09:30 to 12:30



Mail contact :
campingsaintmalo@gmail.com

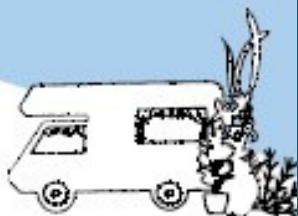



Our rentals

You've decided to spend a few days camping in one of our accommodation options and you're still not sure which type of Coco to choose?

With its original design and level of comfort, Coco appeals to all types of customer: first-time campers, nature lovers, sports enthusiasts, couples, families, friends... Its atypical look allows you to create your own space, oriented towards nature, distinct from the areas given over to tents and mobile homes.

The Cité d'Aleth campsite has : 6 Coco Sweet - 4 Coco Chrono - 4 Coco Salle d'Ô



Coco is 100% recyclable, consumes little energy and respects the environment.



Coco Sweet

visit



Coco Chrono

visit



Coco Salle d'Ô

visit





Coco Sweet

2 rooms - 4 pers. max.

*Pure, taut lines and bold colours,
Coco's design celebrates simplicity
and recaptures the Lodge spirit, with a French touch.*



The living room

Want to relax indoors? Opt for the comfortable bench seats with their cushions (which can be converted into a children's bedroom with 2 single beds); and for added comfort, use the blackout curtains. There's also plenty of practical storage space.



The kitchen

The Coco's interior features a kitchenette with a work surface for preparing delicious meals, a fridge and microwave, practical storage space and a fold-out table with stools.



The bedroom

The parents' bedroom is equipped with a double bed with a hotel-quality mattress, shelves with hanging space for storage, a mirror and blackout curtains for a good night's sleep.

Plan

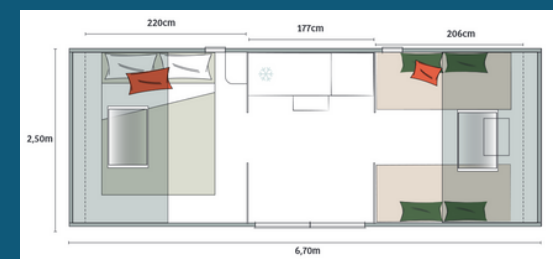

Equipment

- refrigerator table top
- work plan
- kitchen utensils
- dining table and 4 stools
- open and closed storage areas
- 2 bench seats with bedspreads that can be converted into 2 single beds (80x90 cm)
- 1 double bed (140x90 cm) 35kg/m3 high resilience foam mattress with OEKO TEX label
- sleeping kit (on request)
- 4 natural white cushions
- blackout blinds
- blackout curtain to separate living room



Coco Sweet has no water supply
or sanitary facilities



Coco Sweet

visit





Coco Chrono

2 rooms - 4 pers. max.

*Pure, taut lines and bold colours,
Coco's design celebrates simplicity
and recaptures the Lodge spirit, with a French touch.*



The living room

Want to relax indoors? Opt for the comfortable bench seats with their cushions (which can be converted into a children's bedroom with 2 single beds); and for added comfort, use the blackout curtains. There's also plenty of practical storage space.



The kitchen

The Coco's interior features a kitchenette with a work surface for preparing delicious meals, a fridge and microwave, practical storage space and a fold-out table with stools.



The bedroom

The parents' bedroom has a double bed with a hotel-quality mattress, shelves with hanging space for storage, a mirror and blackout curtains for a good night's sleep.

Plan



Equipment

- refrigerator table top
- work surface
- dining table and 4 stools
- open and closed storage areas
- 2 bench seats with bedspreads that can be converted into 2 single beds (80x90 cm)
- 1 double bed (140x90 cm) 35kg/m³ high resilience foam mattress with OEKO TEX label
- 4 natural white cushions
- blackout blinds
- blackout curtain on living room divider



le Coco Chrono n'a pas d'arrivée d'eau
ni de sanitaire



Coco Chrono

visit





Coco Salle d'Ô

2 rooms - 4 pers. max.



The living room

Want to relax indoors? Opt for the comfortable bench seats with their cushions (which can be converted into a children's bedroom with 2 single beds); and for added comfort, use the blackout curtains. There's also plenty of practical storage space.



The kitchen

The interior of the Coco has a kitchenette with a work surface for preparing tasty meals, a fridge and microwave, practical storage space and a fold-out table with stools. Each campsite can provide a small appliance kit (coffee maker, toaster, kettle, etc.) and a hob.



The bedroom

The parents' bedroom has a double bed with a hotel-quality mattress, shelves with hanging space for storage, a mirror and blackout curtains for a good night's sleep.



The shower room

You want to add an extra level of comfort with a shower room and separate toilet.

Coco salle d'Ô offers the comfort of a shower room and WC included in the accommodation, for those who want everything under their own roof.

Plan

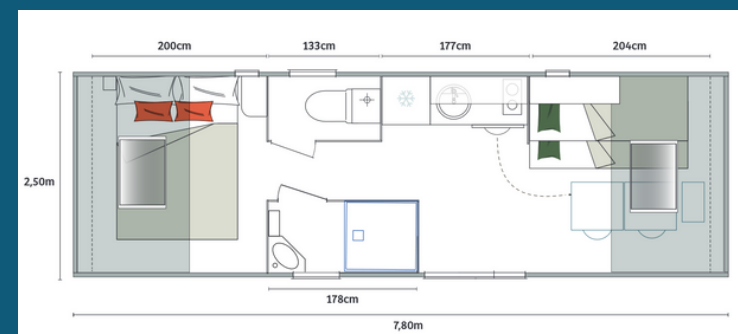

Equipment

table-top refrigerator / sink / 2-burner ceramic hob
work surface
dining table and 4 stools
shower tray (80x80cm) / washbasin unit / towel rail
separate WC

open and closed cupboards
2 single beds (70x90cm) 35kg/m3 high resilience foam mattress with OEKO TEX label

1 sofa bed 1 double bed (130x90cm)
1 blackout curtain to separate living area
3 natural white cushions
round mirror
blackout blinds for windows



Coco Salle d'Ô

visit



2024 RATES

LOCATIONS

Coco-sweet - 4 pers.

65€ / night (min. 2 nights)

75 € / night

Coco Sweet - 4 pers.

445 € / week

515 € / week

Coco Chrono - 4 pers.

75 € / night (2 nights min.)

85 € / night

Coco Chrono - 4 pers.

515 € / week

585 € / week

Coco Salle d'Ô - 4 pers.

85 € / night (2 nights min.)

95 € / night

Coco Salle d'Ô - 4 pers.

585 € / week

655 € / week

Special low season package - hire from Monday to Friday (4 nights) :
Coco Sweet : €220 // Coco Chrono : €260 // Coco Salle d'Ô : €300

LOW SEASON

*from 29/03 to 28/06
from 01/09 to 30/09*

HIGH SEASON

*from 29/06 to 31/08
rental from Sat. to Sat.*

SERVICES

Sleeping kit (Coco rentals)
Cleaning package

ALL SEASON LONG

10 € / bed
80€

Pictures



YOUR BOOKING NOW



mail :
campingsaintmalo@gmail.com



phone : 02 90 63 02 13
every day from 09.30 to 12.30



See you soon!



camping-saintmalo.fr

